

**AIRCRAFT PARKING/ DOCKING CHART**  
**GA AREA**

**APRON ELEV 666 FT**

**OSLO, GARDERMOEN NORWAY**

**NOTES - REMARKS**

**TAXIWAYS**

- C, C1, C2 and C3: 23 M wide.
- C4: 18 M wide.

**APRON GA NORTH**

- Fueling only permitted on designated fueling pad.

**APRON GA CENTRAL**

- Parking limited to aircraft with special permission.
- Marshalling service mandatory.
- Fueling only permitted on designated fueling pad.

**APRON GA SOUTH**

- Open apron with no aircraft stand marking.
- Marshalling service mandatory.
- Fueling only permitted on designated fueling pad.

Runway strength, REF AD 2.12

Apron surface and strength, REF AD 2.8

Taxiway width, MAX wingspan, surface and strength, REF AD 2.8

Declared distances, REF AD 2.13

**COM**

CLR (E)	121.930 MHZ
CLR (W)	121.680 MHZ
GND (W)	121.605 MHZ
TWR (E)	120.105 MHZ
TWR (W)	118.305 MHZ
ACCESS OSLO	131.910 MHZ
SUNDT AIR	134.175 MHZ

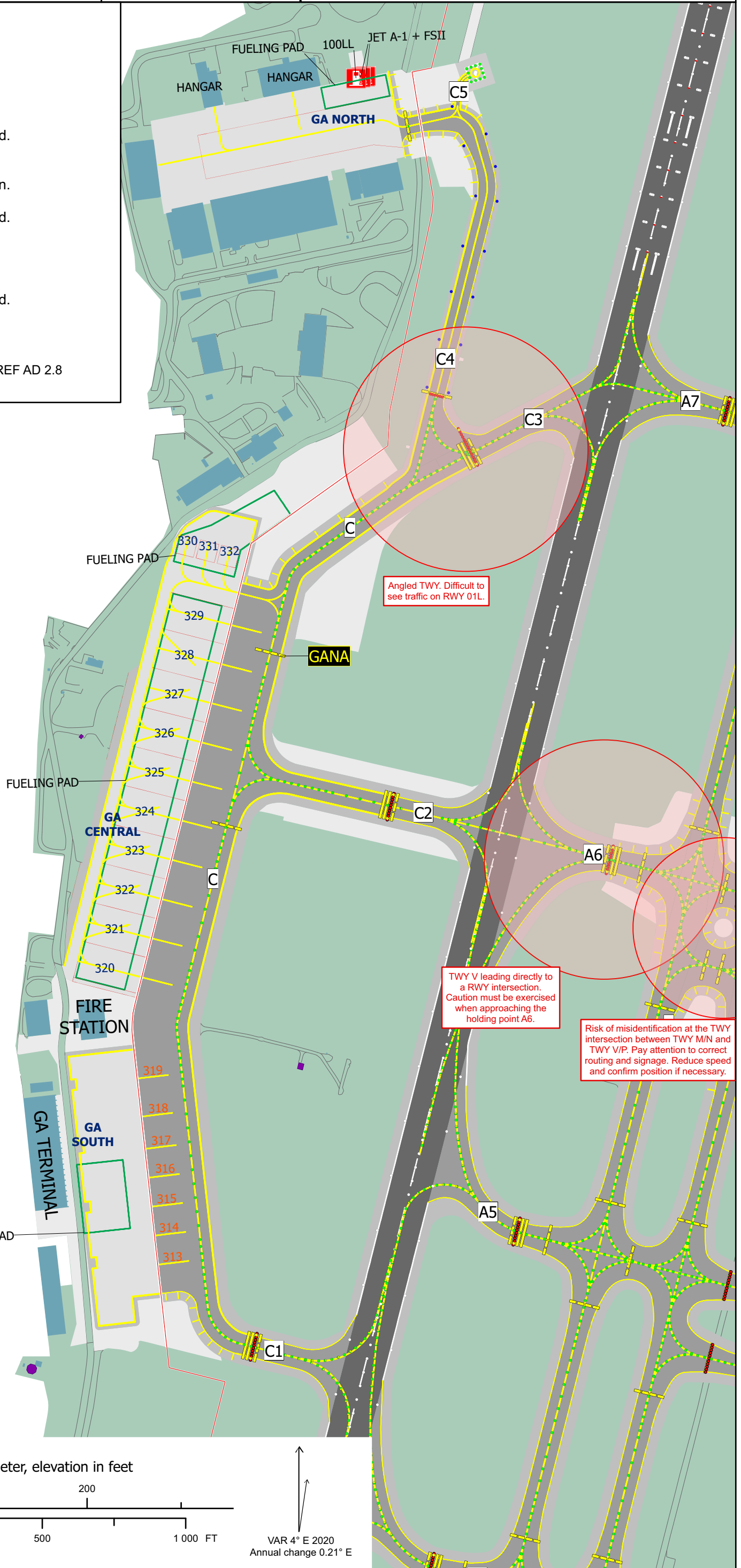

Angled TWY. Difficult to see traffic on RWY 01L.

TWY V leading directly to a RWY intersection. Caution must be exercised when approaching the holding point A6.

Risk of misidentification at the TWY intersection between TWY M/N and TWY V/P. Pay attention to correct routing and signage. Reduce speed and confirm position if necessary.

CHANGES: GA NORTH, FUELING PAD RELOCATED, NEW TWY C5, EDITORIALS.

**Legend**

- 5 Stand number
- 5 Lead-in line number
- △ Release point on taxiway
- ⊗ No entry RWY
- ⊗ No entry TWY
- ▭ Visual Docking Guidance System
- Manoeuvring Area Boundary
- ▨ Fire drill area
- ▨ Engine Testing Area
- ▨ Non accessible area
- ▨ Construction area
- ▨ De-Ice
- ⚠ Storage of dangerous goods
- ✈ Parking for aircraft carrying dangerous goods

**SCALE: 1:4 300**  
Dimensions in meter, elevation in feet

VAR 4° E 2020  
Annual change 0.21° E